

These are the notes referred to on the following official copy

The electronic official copy of the title plan follows this message.

Please note that this is the only official copy we will issue. We will not issue a paper official copy.

This official copy was delivered electronically and when printed will not be to scale. You can obtain a paper official copy by ordering one from Land Registry.

If any mapping work in respect of any pending application(s) has been completed, additional references, which are not referred to in the register of title, may appear on the title plan or be referred to in the certificate of inspection in form CI. References may also have been amended by, or not be shown on the title plan, where these are being removed as a result of a pending application(s).

This official copy is issued on 16 April 2013 shows the state of this title plan on 16 April 2013 at 10:42:42. It is admissible in evidence to the same extent as the original (s.67 Land Registration Act 2002). This title plan shows the general position, not the exact line, of the boundaries. It may be subject to distortions in scale. Measurements scaled from this plan may not match measurements between the same points on the ground. See Land Registry Public Guide *19 - Title Plans and Boundaries*.

This title is dealt with by the Land Registry, Nottingham Office .

Land Registry Official copy of title plan

Title number **WYK926230**
Ordnance Survey map reference **SE1416SW**
Scale **1:1250**
Administrative area **West Yorkshire : Kirkles**

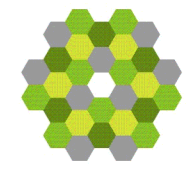

© Crown copyright and database rights 2013 Ordnance Survey 100026316. You are not permitted to copy, sub-license, distribute or sell any of this data to third parties in any form.

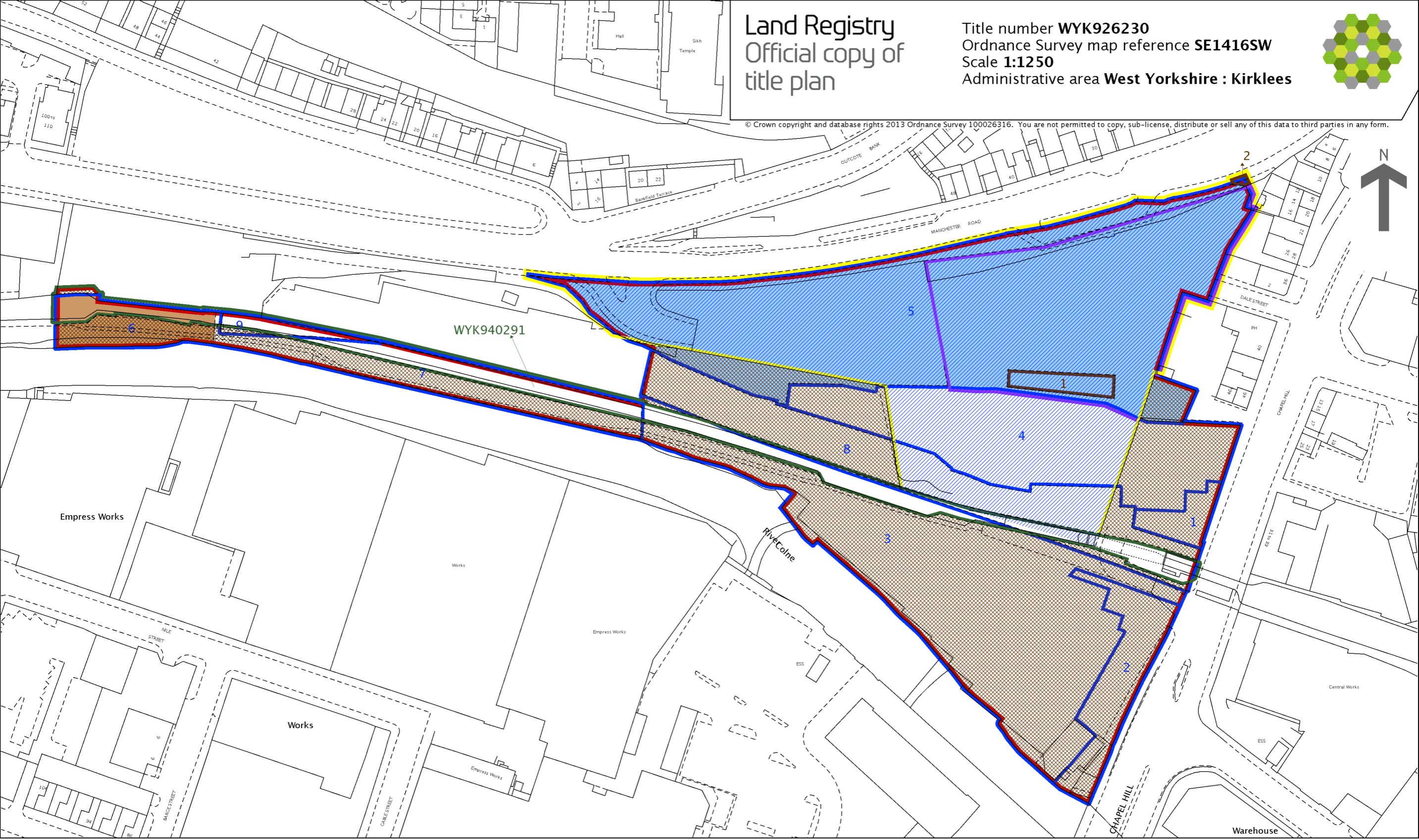

WYK940291